

PLAN SHOWING THE PLOT HAVING AREA 76 DECIMAL MORE OR LESS INSIDE RS PLOT NO 550 KHATIAN NO- 447 INSIDE MOUZA- ARRAH, JL NO- 91, PS- KANKSA, DIST- PASCHIM BURDWAN, WEST BENGAL SHOWN WITH RED BORDER THUS-

NAME OF PROJECT- PATIKRIT COMPLEX

NAME OF OWNER- JOHIRUL ISLAM
S/O LUTFAL HAQUE
20/12 ASHOK AVENUE, DURGAPUR-4
PS- DURGAPUR, DIST- PASCHIM BURDWAN, W.B.

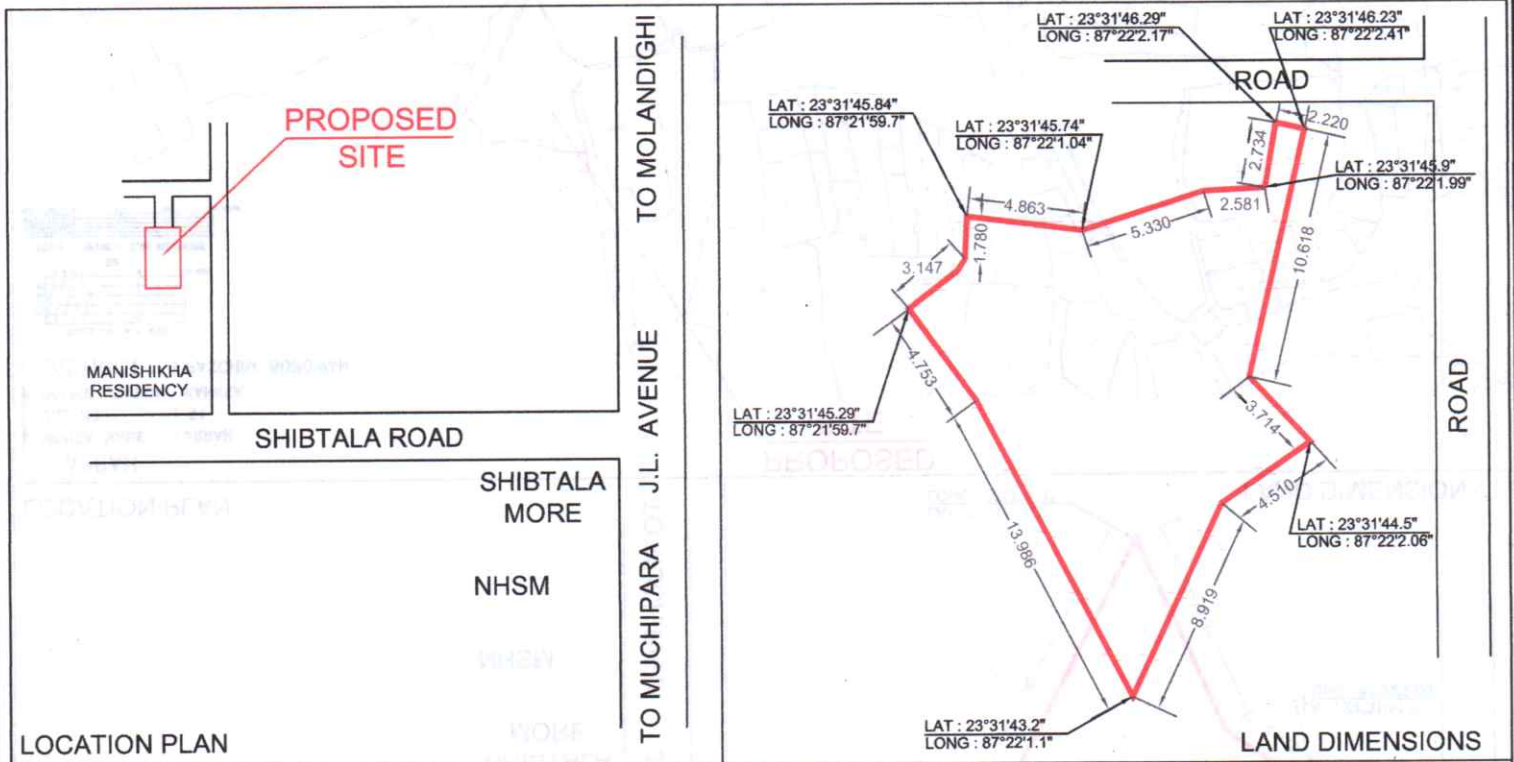

LOCATION PLAN

LAND DIMENSIONS

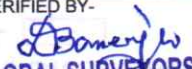

<p>PREPARED BY- GLOBAL SURVEYORS REGD OFFICE- SEARSOLE BABUPARA P.O.- SEARSOLE RAJBARI, DIST.-PASCHIM BURDWAN (W.B.) PH- 94342 37231, 9933738261 EMAIL- info@globalsurveyors.org globalsurveyors2017@yahoo.co.in WEBSITE- www.globalsurveyors.org (AN ISO 9001:2015 CERTIFIED FIRM)</p>	<p>DIRECTION</p> 	<p>DRAWING NO- DATE 20.05.2023 GS/MIPL/2023/ MPLAN/1 OF 4</p>	<p>SIGNED & VERIFIED BY-  GLOBAL SURVEYORS "PUSPANJAL" SEARSOLE BABU PARA P.O. SEARSOLE RAJBARI, PS. BANIGANI PIN-713358 DIST. PASCHIM BARDHAMAN (W.B.)</p>
---	--	---	--